

RACCORDI RECUPERABILI RE-USABLE FITTINGS

FEMMINA SEDE OGIVA FEMALE SPHERICAL SEAT

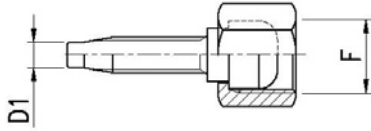

Codice Code	DN Tubo ND Hose		Filetto Thread F	L1
	mm	inch		
RKPR14G ^[X]	4	5/32"	1/4" G	4
RKPR14M ^[X]	4	5/32"	1/4" MPSPM	4
RKPR38G ^[X]	4	5/32"	3/8" G	4
RKPR38M ^[X]	4	5/32"	3/8" MPSPM	4
RKPR1615 ^[X]	4	5/32"	M16x1.5	4

[X] Su richiesta per raccordo in acciaio inox aggiungere la lettera "X"
On request for stainless steel fittings add the letter "X"

PERNO DIRITTO RACCORDO ERMETO PIN STRAIGHT ERMETO FITTINGS

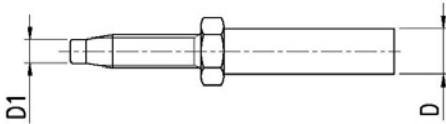

Codice Code	D	D1
RKER4 ^[X]	4	4
RKER6 ^[X]	6	4
RKER8 ^[X]	8	4

[X] Su richiesta per raccordo in acciaio inox aggiungere la lettera "X"
On request for stainless steel fittings add the letter "X"

PERNO 90 RACCORDO ERMETO PIN 90° FOR ERMETO FITTINGS

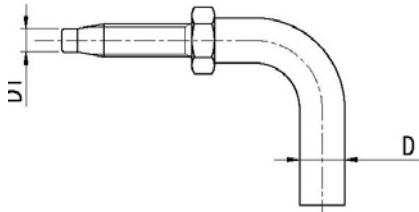

Codice Code	D	D1
RKER490 ^[X]	4	4
RKER690 ^[X]	6	4
RKER890 ^[X]	8	4

[X] Su richiesta per raccordo in acciaio inox aggiungere la lettera "X"
On request for stainless steel fittings add the letter "X"

BOCCOLA A PRESSARE FERRULES TO CRIMP

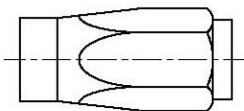

Codice Code	DN Tubo / ND Hose			
	DN	Size	inch	mm
RK01005-04 ^[X]	4	02	5/32"	4
RK01007-04 ^[X]	4	02	5/32"	4

[X] Su richiesta per raccordo in acciaio inox aggiungere la lettera "X"
On request for stainless steel fittings add the letter "X"

Adatti per i nostri tubi: D6 - D7 - D11

Suitable for our hoses: D6 - D7 - D11